



www.grupomolduras.com

Products Catalog



Índice

04 Interior timber cladding

The most attractive side of wood
Subtle natural finishes
A touch of glamour
The beautiful of the old
Wood wood...
Colour and texture
Play, combine and decorate

16 Exterior timber cladding

Floor
Facade

12 Acoustics. Interior timber cladding

Nobleacoustic, semiacoustic
Maximum acoustic response
International acoustic surface

21 Fireproof timber cladding

Find the finish you are looking for

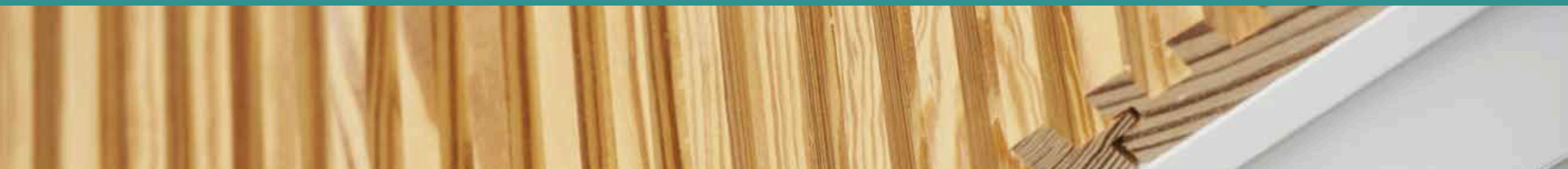



100% RESPECTFUL

100% Respectful

All Molduras del Noroeste's products are manufactured with an absolute respect for the environment.

- We use certified wood from ecologically sustainable controlled reforestation plantations.
- We use water-based, odourless and non-flammable varnishes with a minimal environmental impact.

By choosing Molduras del Noroeste's cladding for walls, ceilings, and floors, you will be helping to improve the environment:

- Because wood plays a crucial role in the fight against climate change. An increased use of wood from certified forests encourages the expansion of this type of controlled plantations.
- Because wood is a natural, abundant and renewable resource. Responsible forest management practices ensure that the wood supply is not only sustainable, but also that it increases.
- Because it is the only raw material with the capacity to reduce emissions and store CO₂. Forests fix CO₂, wood-derived products retain it, and recycling allows the retention of carbon dioxide to be prolonged. Each cubic metre of wood stores 0.9 tonnes of CO₂.
- Because a 4% annual increase in the consumption of wood products in Spain is equivalent to savings amounting to 1.3 million tonnes of CO₂ in emissions.
- Because it is sustainable and efficient: compared to other materials, wood is a raw material that requires a lower energy consumption to manufacture the products derived from it.

Thank you for your involvement.



Interior timber cladding





INTERIOR TIMBER CLADDING

THE MOST ATTRACTIVE SIDE OF WOOD

The combination of the silk varnish with the innovative range of wood shades accentuates the hue of the grains and highlights the beauty of the natural cladding. Wengue, Champagne, Cappuccino are some of the shades offered to cover stylish, sophisticated, and contemporary areas,...

FINISHES





INTERIOR TIMBER CLADDING

SUBTLE NATURAL FINISHES

A wooden wall in the living room! This was something very common in the past, but has been lost over time due to the so-called modernisation of homes. With a seamless cladding model, you will once again take it into account when designing your space, installed as it always was in wooden houses, but with the comfort provided by profiles and the new style offered by Molduras del Noroeste's new range of finishes. We pursue warmth, the smell of wood, comfort, style, and the wellbeing having a natural material gives a home, office, commercial space...

FINISHES





INTERIOR TIMBER CLADDING

A TOUCH OF GLAMOUR

An often hidden side of wood. The richness of its grain and the diversity of its shades acquire a great decorative potential when we chose the appropriate finish combined with textile elements, colours, decorative elements and furniture of the area.

The range of sophisticated varnishes enhanced by a "rustic silk" finish will add a decorative extra to the space and you will find it hard to choose one: nordic white, stone grey, intense black, gold and silver.

FINISHES



BARNIZ BLANCO NÓRDICO



BARNIZ GRIS PIEDRA



BARNIZ NEGRO INTENSO

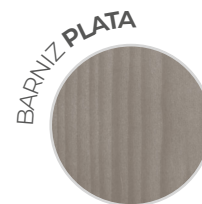

BARNIZ PLATA



BARNIZ CHAMPAGNE



BARNIZ CAPUCCINO



BARNIZ BEIGE



BARNIZ ORO



INTERIOR TIMBER CLADDING

THE BEAUTY OF THE OLD

Wood is a material of great value and like wine, it improves over time. Its texture acquires nuances, and shades become richer; those are the values that the "rustic vintage" finish seeks to convey, a texture providing a natural ageing and wear effect to wood.

Applied on wood shades, the cladding will emphasise the spirit of respect for a redesigned space. Applied on white, grey or black dyes, it will give a special character, perhaps a vintage touch...?

ACABADOS





INTERIOR TIMBER CLADDING

WOOD WOOD...

A cladding option with natural finishes. Sawn textures to enjoy the balance brought by the perception of wood in its rawest state, with its natural smell, its rough touch and texture, almost freshly cut wood.

Natural beauty at the disposal of decor. A range of light colours: natural, bleached or greyish, complete the combination of possibilities of the sawn texture.

FINISHES





INTERIOR TIMBER CLADDING

COLOUR AND TEXTURE

You can see it and feel it. To refine the description of this full range of finishes, it should also be pointed out that its natural origin can be smelt, and that is a feature of all Molduras' solid wood cladding. This variety of finishes is marked by having a silky, smooth texture, which can be felt in the touch and seen with one's eyes.

And colour cannot be an excuse. From the subtle sleet white, grey haze or brown, trail to the expressive purple horizon or sunrise Red,... The Basic and Natura Color range is formed by 10 shades, all of them with the rustic satin effect.

FINISHES

BASIC BLANCO

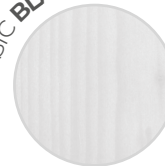

BASIC MARRÓN

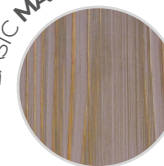

BASIC GRIS

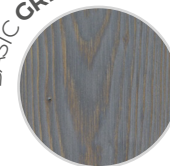

BASIC VERDE

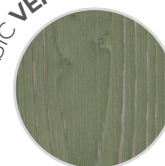

NATURA COLOR BLANCO NEVISCA



NATURA COLOR MARRÓN SENDA



NATURA COLOR GRIS BRUMA

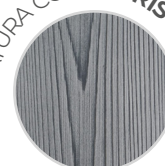

NATURA COLOR MORADO HORIZÓN



NATURA COLOR NATURAL





INTERIOR TIMBER CLADDING

PLAY, COMBINE AND DECORATE

Having a wide variety of finishes makes the approach and the design of the spaces easier, but if we can also play with dimensions, the possibilities are multiplied.

Molduras del Noroeste offers different slat widths within its cladding range, which can be combined amongst each other. As they share a unified compatible anchorage system, you can play by combining broad and narrow bands, inserting others with intermediate width... You can also mix slats of different lengths... or maybe combine finishes, inserting a different colour band to create a sophisticated design.

PROFILES

528

FINISHES

Wide range. See the compatibility chart.



Acoustics. Interior timber cladding





ACOUSTICS. INTERIOR TIMBER CLADDING

NOBLEACUSTIC, SEMIACUSTIC

AN ACOUSTIC LEVEL FOR EVERY NEED. Natural wood cladding with four levels of acoustic damping. The models can be combined with each other and with non-acoustic coatings. A proper selection of the model and increasing the percentage of acoustical cladding allows any space to obtain the desired acoustic damping.

The new line from MOLDURAS DEL NOROESTE has maximum absorption around the frequencies of interest, which can address an effective acoustic treatment in midrange frequencies and thus verify compliance with the CTE DB HR in those areas that are subject to legal limits (classrooms, conference rooms, restaurants / dining rooms in public buildings, etc). This is the case of the NOBLEACUSTIC and NOBLEACUSTIC INTENSO ranges in medium-high frequencies (profiles R5T16, R5T32).

The SEMIACUSTIC INTENSO and SEMIACUSTIC range complements the NOBLEACUSTIC INTENSO range, allowing the control of reverberation in lower frequencies to be addressed in order to obtain a sound with better tonal balance in rooms that combine both solutions (profiles R2T16, R2T32).

They combine perfectly with profile 528 to help integrate the acoustic performance on walls and ceilings. The spacing and the grooves have a 3.5 mm width, obtaining a very intended effect of a continuous surface.

Very suitable cladding for spaces that require a high decorative level, integrating the service with the environment.

PROFILES

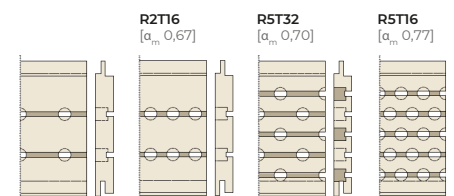

* The data reflects the acoustics absorption coefficient from calculations and tests. For more information on certifications please consult our technical department.



ACOUSTICS. INTERIOR TIMBER CLADDING

MAXIMUM ACOUSTIC RESPONSE

Natural wood cladding with a level of acoustic damping. A design that is focused on highlighting the acoustic performance of the space, made up of five grooves that allow us to sense the acoustic perforations that are distributed forming equidistant columns (profile R5R).

It combines perfectly with profile 528 to help integrate the acoustic performance on walls and ceilings. The spacing and the grooves have a 3.5 mm width, obtaining a very intended effect of a continuous surface.

Very suitable cladding for spaces that require a high decorative level, integrating the service with the environment. Hotels, press rooms, offices, classrooms and training areas, as well as restaurants, cafeterias and discotheques are examples that accommodate this new range.

PROFILES

R5R
[α_m , 0,75]

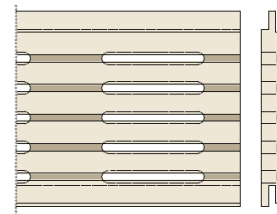

* The data reflects the acoustics absorption coefficient from calculations and tests. For more information on certifications please consult our technical department.



ACOUSTICS. INTERIOR TIMBER CLADDING

INTENTIONAL ACOUSTIC SURFACES.

Natural wood cladding with a high level of acoustic damping.

A model that seeks a protagonist effect in areas where it is installed, with a design marked by a mosaic with visible circles that interfere with the grooved effect of its nine spacings.

It combines perfectly with profile 528 to help integrate the acoustic performance on walls and ceilings. The tongue and the grooves have a 3.5 mm width, obtaining a very intentioned effect of a continuous surface.

Very suitable cladding for spaces that require a high decorative level, integrating

the service with the environment. Designed to cover large surfaces. Very suitable for open and airy spaces where a high decorative level is required, accompanied by the acoustic solution: atriums, reception halls, corridors of administrative areas, auditoriums, entertainment and rehearsal rooms, airports, tube, bus or train stations ...

PROFILES

R9T64
[α_m 0,74]

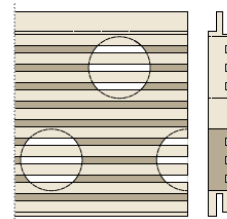

* The data reflects the acoustics absorption coefficient from calculations and tests. For more information on certifications please consult our technical department.



Exterior cladding





EXTERIOR CLADDING

FLOOR

Product line for exterior floors. Natural cladding treated in autoclave treatment certified for class 4 use. The outdoor treatment protects the wood against fungal degradation (live agents that feed from wood and destroy it, mainly insects and fungi).

Wide range of finishes. The natural finish and teak lasur which already exist are joined by the stone grey, which extends the application options, covering a wide range of architectural styles: rustic style gable cottages, versatile natural shelters or modern houses where the matching straight volumes mark the aesthetic lines.

Multiple domestic uses: areas close to swimming pools, paths that connect different areas of the garden or terrace areas. Or public spaces: walks, terraces for the foodservice channel or to complement landscaped areas.

PROFILES

560, 561, 563 y 565

FINISHES





EXTERIOR CLADDING

FLOOR

Product line for exterior floors. Natural cladding treated in autoclave treatment certified for class 4 use. The outdoor treatment protects the wood against fungal degradation (live agents that feed from wood and destroy it, mainly insects and fungi).

Wide range of finishes. The natural finish and teak lasur which already exist are joined by the stone grey, which extends the application options, covering a wide range of architectural styles: rustic style gable cottages, versatile natural shelters or modern houses where the matching straight volumes mark the aesthetic lines.

Multiple domestic uses: areas close to swimming pools, paths that connect different areas of the garden or terrace areas. Or public spaces: walks, terraces for the foodservice channel or to complement landscaped areas.

PROFILES

560, 561, 563 y 565

FINISHES





EXTERIOR CLADDING

FACADE

Product line for exterior cladding Natural cladding treated in autoclave treatment certified for class 4 use. The outdoor treatment protects the wood against fungal degradation (live agents that feed from wood and destroy it, mainly insects and fungi).

Wide range of finishes. The natural finish and teak lasur already known are joined by the nordic white and stone grey which notably extend the application options, covering a wide range of architectural styles: rustic gable cottages, versatile natural shelters or modern houses where the matching straight volumes mark the aesthetic lines.

PROFILES

**560, 561, 563, 565,
559, 581, 945, 946
y 949**

FINISHES





EXTERIOR CLADDING

FACADE

Product line for exterior cladding Natural cladding treated in autoclave treatment certified for class 4 use. The outdoor treatment protects the wood against fungal degradation (live agents that feed from wood and destroy it, mainly insects and fungi).

Wide range of finishes. The natural finish and teak lasur already known are joined by the nordic white and stone grey which notably extend the application options, covering a wide range of architectural styles: rustic gable cottages, versatile natural shelters or modern houses where the matching straight volumes mark the aesthetic lines.

FINISHES

**560, 561, 563, 565,
559, 581, 945, 946
y 949**





Fireproof timber cladding





FIREPROOF TIMBER CLADDING

FIND THE FINISH YOU ARE LOOKING FOR

Modern and natural finishes that follow the latest trends in interior design; Live textures that emphasise the value of the wood, with a recently sawn rough finish or simulating wood ageing with a total authenticity; Sophisticated varnishes with elegant and subtle shades, and especially, really original varnishes matching the latest designer furniture. Flick through the pages of this catalogue to find which one best suits your decorative style.

B-s2, d0 / B-s1, d0 / BFL-s1. This adds an invisible layer of security to all your cladding. Molduras exclusive fireproof timber cladding adds a barrier against fire to areas where it is installed. The wood is treated in autoclave with a proprietary fireproof protector using vacuum-pressurevacuum cycles, so that the protector completely penetrates the wood. Subsequently, the wood is dried and processed. In order to boost the fireproof effect, timber cladding is subject to a varnishing process.

Technical building code. Since 2005, this code lays down a series of requirements that must be complied with. Section DB-SI (Fire safety basic document) sets the minimum requirements to be met by products and elements in the building industry. The AFITI-LICOF fire laboratory, accredited by ENAC (National Accreditation Entity), certifies the compliance of Molduras del Noroeste's cladding labelled as fireproof.

This feature is optional in our cladding and is exclusive in the industry. It can be applied to a wide variety of our interior products (walls, ceilings, and floors), without changing the final appearance of the finish.



B-s2, d0
PINE WALL CLADDING

B-s1, d0
SLATS

BFL-s1
FLOORING (FLOORBOARDS)

PROFILE				FINISHES (spruce / red pine) PEFC and CE																												OTHER WOODS (CE)					
REF.	Slat width (mm.) (size includes tongue and groove)	Slat thickness (mm.)	Maximum slat length (mm.)	Natural: Natural spruce	Light spruce varnish	Honey spruce or pine (stained wood)	Grey mist varnish	Beige varnish	Champagne varnish	Cappuccino varnish	Wenge varnish	Nordic white varnish	Stone grey varnish	Intense Black varnish		Gold varnish	Silver varnish	Soft grey varnish	Soft blue varnish	White Lacquer (gloss or matt)	White (Basic)	Green (Basic)	Brown (Basic)	Grey (Basic)	Sleek white (Natural Color)	Brown trail (Natural Color)	Grey haze (Natural Color)	Sunrise red (Natural Color)	Purple horizon (Natural Color)	Classic walnut (stained wood)	Classic green (stained wood)						
520	45 / 70 / 95 120* / 145**	10 / 13 / 17	Natural (MN): 4.8m Barnizado satinado (B): 4.8m Barniz seda (BS): 3m Natura y Basic: 3m Teñido: 3.9m	MN / B / BS / RS / RV	BS	B	BS	BS	BS	BS	BS	BS	BS	BS				BS	BS	B										RS	RS						
524	95 / 120*	10 / 13		MN / B / RV / BS	BS	B	BS	BS	BS	BS	BS	BS	BS	BS	BS				BS	BS	B																
527	95 / 120* 145**	10 / 13 / 17		MN / B / BS / A / RV / RS	BS / A / RV / RS	B	BS / RV	BS / RV	BS / RV	BS / RV	BS / RV / RS	BS / RV / RS	BS / RV / RS	BS / RV / RS	BS / RV / RS		BS / RS	BS / RS	BS	BS	B	RS	RS	RS	RS	RS	RS	RS	RS	RS	RS	RS					
528	45 / 70 / 95 120* / 145**	10 / 13 / 17		MN / B / BS / A / RV / RS	BS / A / RV / RS	B	A / BS / RV / RS	A / BS / RV / RS	A / BS / RV / RS	A / BS / RV / RS	A / BS / RV / RS	A / BS / RV / RS	A / BS / RV / RS	A / BS / RV / RS	A / BS / RV / RS		BS / RV / RS	BS / RV / RS	BS / RV / RS	BS / RV / RS	B	RS	RS	RS	RS	RS	RS	RS	RS	RS	RS	RS					
530	45 / 70 / 95 120* / 145**	10 / 13 / 17		MN / B / BS / RV / RS	BS	B	BS	BS	BS	BS	BS	BS	BS	BS	BS				BS	BS	B	RS	RS	RS	RS	RS	RS	RS	RS	RS							
550	95 / 120* 145**	13 / 17		MN / BS / A / RV / RS	BS / A / RV		RV	RV	RV	RV	RV	RV	RV	RV	RV						B																
CHECK AVAILABILITY																																					

PROFILES

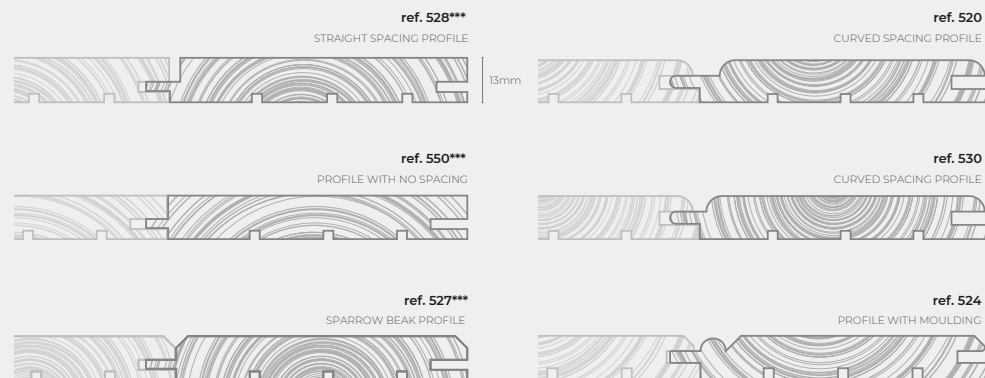

* 120 mm wide profiles are only available in 13 mm and 17 mm thickness.

** 145mm wide large format profiles are only available in 17mm thickness.

*** COMPATIBLE ANCHOR SYSTEM, AND COMBINABLE BETWEEN DIFFERENT PROFILES.

FINISHES

MN - NATURAL WOOD

Standard treatment provided in a raw and smooth brushed finish.

B - SATIN VARNISH

Treatment with a glossy looking varnish, and smooth finish to the touch.

BS - SILK VARNISH

Finish with a water-based matt varnish, smooth surface pleasant to touch surface. It is offered in a wide variety of hues.

A - SAWN

Natural looking treatment, with raw effect surface, rough to the touch. Chips and natural imperfections seen.

RV - RUSTIC VINTAGE

Controlled treatment to give an intentional aged effect, small cracks and irregularities in the natural wood are enhanced. Rough touch.

RS - RUSTIC SILK

Rich surface finish showing the relief of the grain. Matt appearance, soft and pleasant to touch.



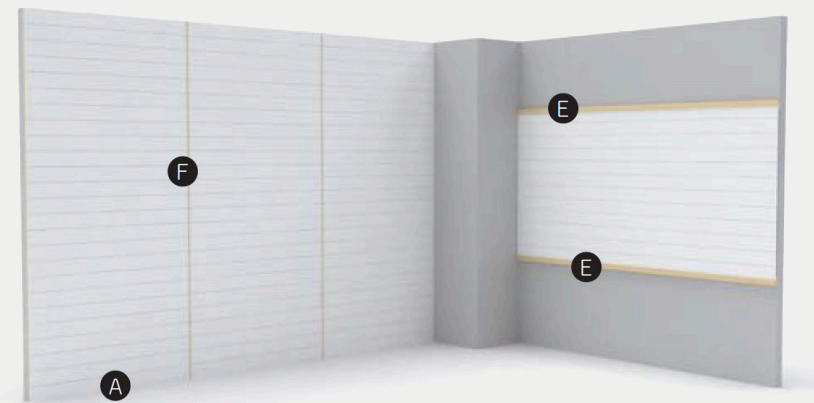
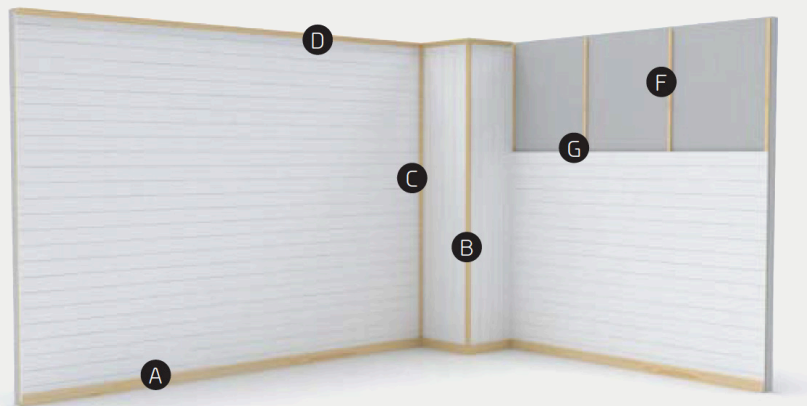

A) MOULDED SKIRTING BOARD

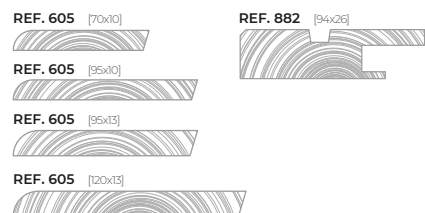

A) STRAIGHT SKIRTING BOARD

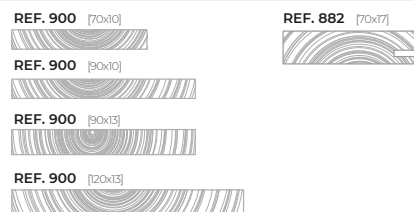

B) MOULDED OUTSIDE CORNER GUARD B



B) STRAIGHT OUTSIDE CORNER GUARD



C) MOULDED INSIDE CORNER GUARD

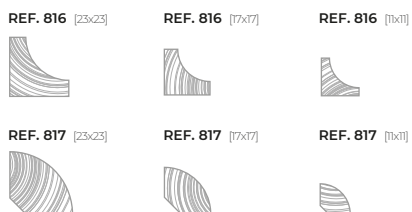

C) STRAIGHT INSIDE CORNER GUARD



D) MOULDED CORNICES

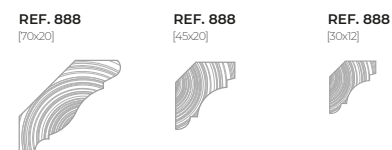

D) STRAIGHT CORNICE



E) FINISHES



E) STRAIGHT FINISHES



F) BATTENS

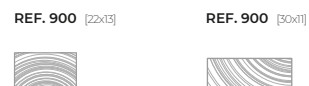



G) CLIP



PROFILE		FINISHES (spruce / red pine) PEFC and CE					OTHER WOODS (CE)
REF.	Slat width and thickness (mm.) (size includes tongue and groove)	Spruce or red pine natural varnish	Nordic white varnish	Cappuccino varnish	Stone varnish	Wenge varnish	
550	95x22	MN	BP / RP	BP / RP	BP / RP	BP / RP	Oak, Tea, Galician pine. CHECK AVAILABILITY

ACCESSORIES

A) SKIRTING BOARDS	
REF. 605 	70 x 10 95 x 10 95 x 13 120 x 13
B) BATTENS	
REF. 900 	30 x 22

FINISHES

MN - NATURAL WOOD

Standard treatment provided in a raw and smooth brushed finish.

BP - PROTECTION VARNISH

Finish with a water-based matt varnish, in a wide range of tones. Treatment with a matt appearance varnish, and smooth finish to the touch.

RP - RUSTIC PROTECTION

Rich surface finish showing the relief of the grain. Treatment with a matt appearance varnish, and smooth finish to the touch.



PROFILE



COMPATIBILITY CHART

PROFILE					FINISHES (spruce / red pine) PEFC and CE														OTHERS WOODS (CE)
REF.	Model	Slat width and thickness (mm.) (size includes tongue and groove)	Absorption coefficient α_m	Maximum slat length (mm.)	Spruce or red pine	Grey mist varnish	Beige varnish	Champagne varnish	Cappuccino varnish		Wenge varnish	Nordic white varnish	Stone grey varnish	Intense Black varnish	Gold varnish	Silver varnish	Soft grey varnish	Soft blue varnish	
525	R2T32	96x13	0,50	Natural (MN): 4,8m Barniz seda (BS): 3m	MN	BS	BS	BS	BS		BS	BS	BS	BS	BS	BS	BS	BS	CHECK AVAILABILITY
	R2T16	96x13	0,67		MN	BS	BS	BS	BS		BS	BS	BS	BS	BS	BS	BS	BS	
	R5T32	96x13	0,70		MN	BS	BS	BS	BS		BS	BS	BS	BS	BS	BS	BS	BS	
	R5T16	96x13	0,77		MN	BS	BS	BS	BS		BS	BS	BS	BS	BS	BS	BS	BS	
	R5R	96x13	0,75		MN	BS	BS	BS	BS		BS	BS	BS	BS	BS	BS	BS	BS	
	R9T64	96x13	0,74		MN	BS	BS	BS	BS		BS	BS	BS	BS	BS	BS	BS	BS	

PROFILES

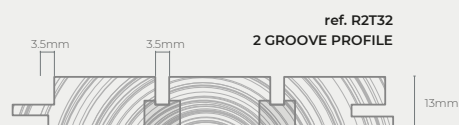

FINISHES

MN - NATURAL WOOD

Standard treatment provided in a raw and smooth brushed finish.

BS - SILK VARNISH

Finish with a water-based matt varnish, smooth surface pleasant to touch surface. It is offered in a wide variety of hues.



ACCESSORIES

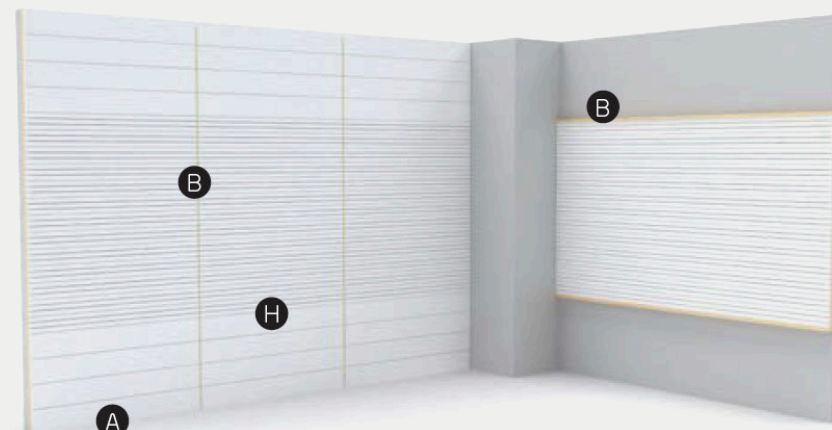
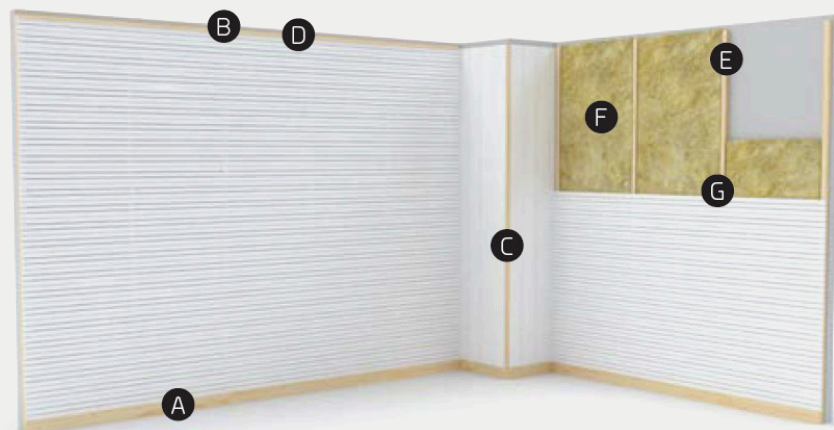

A) SKIRTING BOARDS

REF. 882 [34x26]

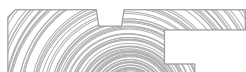

REF. 882 STRAIGHT SKIRTING BOARD
[70x17]



REF. 882 STRAIGHT SKIRTING BOARD
[70x10]



B) FINISHES

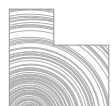

REF. 870
SIDE FINISH
[47x47]



REF. 900
PANELLED SEPARATOR
[11x47]

C) OUTSIDE CORNER GUARD



REF. 814 OUTSIDE CORNER
[21x21]

D) CORNICE - INSIDE CORNER GUARD



REF. 900 COVER
[21x4]

E) BATTENS



REF. 900 BATTEN [30x30]

F) WOOL



REF. - WOOL
[25 thickness / width 120m. /
15m long coil]

G) CLIP



REF. STEEL CLIP FOR THE CLADDING
[23x24]

H) COMPATIBLE PROFILES

REF. 528 [45x13]



REF. 528 [95x13]



REF. 528 [120x13]



COMPATIBILITY CHART

PROFILE				FINISHES (red pine) PEFC and CE				OTHER WOODS (CE)
	REF.	Slat width (mm.) (size includes tongue and groove)	Maximum slat length (m.)	Natural Exteriors	Nordic white varnish (EXCLUSIVE FOR APPLICATION ON FACADES)	Stone grey varnish	Teak lasur	
FLOOR / FACADE	560	95x22 145x45	Natural (NE): 4.5m Acabados (BS, RS y A): 3m (Other lengths please consult)	NE / A	BS / RS / A	BS / RS / A	BS / RS / A	CHECK AVAILABILITY
	561	95x22		NE	BS / RS	BS / RS	BS / RS	
	563	145x35		NE / A	BS / RS / A	BS / RS / A	BS / RS / A	
	565	95x22		NE / A	BS / RS / A	BS / RS / A	BS / RS / A	
FACADE	559	145x22	Natural (NE): 4.5m Acabados (BS, RS y A): 3m (Other lengths please consult)	NE	BS / RS	BS / RS	BS / RS	CHECK AVAILABILITY
	581	145x22		NE	BS / RS	BS / RS	BS / RS	
	945	145x45		NE	BS / RS	BS / RS	BS / RS	
	946	145x30		NE	BS / RS	BS / RS	BS / RS	
	946	120x22		NE	BS / RS	BS / RS	BS / RS	

PROFILES

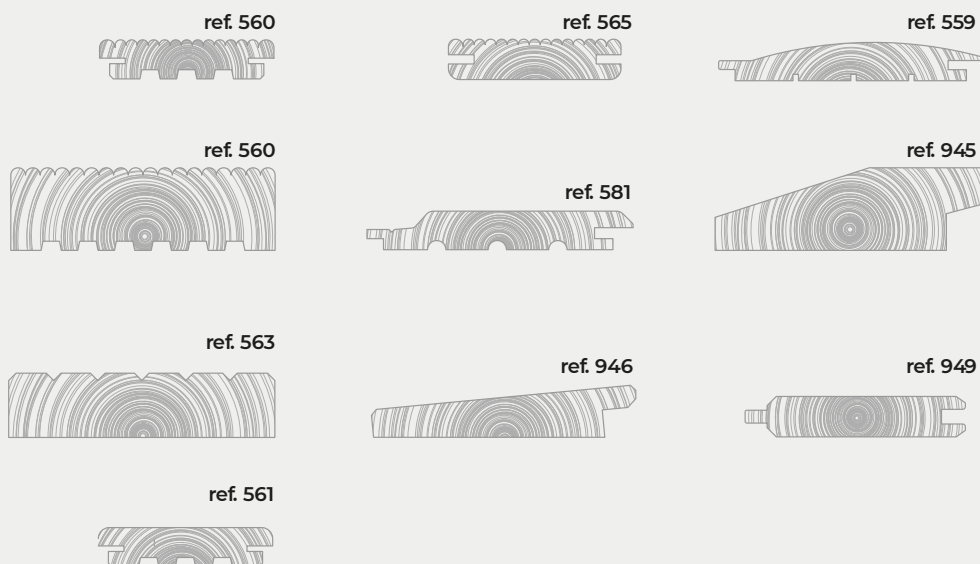

ACCESSORIES

CHANFORA FINISH		JOINT COVERS	
ref. 569 [95x45]		ref. 950 [120x22]	
BATTENS			
ref. 900 [45x22] 	ref. 900 [45x30] 	ref. 900 [45x45] 	ref. 900 [70x22]
ref. 900 [70x45] 	ref. 900 [70x70] 	ref. 900 [95x22] 	ref. 900 [95x45]
ref. 900 [145x22] 	ref. 901 [50x30] 	ref. 920 [95x22] rounded edges 	

CLIPS	
ref. 560/561 [steel] 	ref. 565 [plastic]

FINISHES

NE - NATURAL EXTERIORS

Standard autoclave treatment in a raw tone with a smooth brushed finish.

BS - SILK VARNISH

Finish with a water-based matt varnish, smooth surface pleasant to touch surface. It is offered in a wide variety of hues.

RS - RUSTIC SILK

Rich surface finish showing the relief of the grain. Matt appearance, soft and pleasant to touch.

A - NON-SLIP (only for models 560, 563 and 565)

Standard autoclave treatment with grooved surface. Compatible with all tones.

EXTERIOR CLADDING



GRUPO MOLDURAS

Molduras del Noroeste, s.l. is a company that was created in 1972 in Cambre (A Coruña), specialising in the manufacture of wood solutions for interiors and exteriors.

MISSION: Our mission is to create value in the field of cladding for walls, ceilings and floors, interiors and exteriors, strictly respecting the environment. We target the world of carpentry, DIY and decoration. We provide quality and safety to the construction industry.

VISION: We aim to be a world leader in wood cladding

VALUES: Our values are and have always been our commitment to:

Quality. Molduras del Noroeste was the first company in Spain to implement and certify a quality management system (standard ISO 9001 certificate No. ER-0011/1991). It ensures the continuous training of its workers and they all have adopted this commitment.

All their coatings have the EC Seal. The company holds the following AITIM quality seals: Seal 17- treated wood; Seal 26- solid wood treated with the best provisions for reaction to fire; Seal 4- wood flooring, Seal 29- panelling for interiors/friezes.

Environmental management. It was also one of the pioneers in implementing and certifying an environmental management system (ISO 14001. Certificate No. GA 2000/0025). It uses wood from sustainably managed forests (PEFC certified chain of custody. Certificate No. PEFC / 14-35-00063). Its varnishes and dyes are water based with low VOC emissions. Innovation. Molduras del Noroeste, has about 10 R & D +i projects certified by AENOR, fulfilling the requirements of UNE 166001. Examples of some of these projects are the decorative Natura cladding line; developments that allow the wood to contribute to buildings' security: in the field of fireproofing, leading to fireproof certificates for friezes and flooring; or in the field of sound absorption and reverberation, with its most recent line of acoustic panelling.

Ethics. In Molduras del Noroeste, we have always considered the principle of integrity and ethics as essential support throughout our relationship with the market, society and the environment. This value attached to professionalism, are the main pillars that guide all our actions.



CLASS 3 USE

Wood for outdoors made without direct contact with the floor and not submerged. It may be greatly exposed to the weather, with humidity often exceeding 20%.

It is carried in an autoclave of organic products, with the VAC-VAC, or Vacuum Pressure-Vacuum procedure (for dense wood or with great thicknesses). The treatment does not give the wood any colour, nor increases its moisture.

CLASS 4 USE

Wood for outdoors in contact with the ground, buried or in contact with fresh water, with a permanent humidity above 20%.

It is undertaken in an autoclave using the Bethell system (Vacuum- Pressure Vacuum). It gives wood a green colour. After treatment, the wood should be air dried prior to positioning on site.

PROTECTIVE TREATMENTS

Our accumulated experience and technology allow us to treat wood to increase its resistance in different environments, even outdoors in direct contact with fresh water.

Treatments with the AITIM Quality Seal 17-03 for Treated Wood for Class 3 and 4 Use.

FIREPROOF TREATMENTS

Fireproof treatment, applicable to any wooden element (cladding, beams...) that improves the reaction of wood in case of fire.

Fireproofing treatment is performed in an autoclave, injecting the fireproofing using Vacuum-Pressure Vacuum cycles.

CUSTOMISATION

Need a different cladding for your project? Molduras del Noroeste offers the possibility to manufacture custom coatings with the finish, texture and shape you need.

Check the conditions.



www.grupomolduras.com



CERTIFIED COMPANY



CONTACT US



MOLDURAS DEL NOROESTE S.L.

La Barcala, 10. 15660 Cambre.
A Coruña, (Galicia) España

Tel. +(34) 981 661 358

Fax Admon. +(34) 981 654 553

Fax Comerc. +(34) 981 662 352

info@grupomolduras.com